



Suzhou GaoRun New Energy Technology Co.,Ltd

Add: No.521 nan guan du Road,Wuzhong District,Suzhou, China
Mobile: +91 9910773536, Office: +86(0) 512.65136360/8526;
E-mail: Hitesh.T@gaorunenergy.com, sales@gaorunenergy.com,
Website: www.gaorunenergy.com

JIANGSU GAORUN INTELLIGENT EQUIPMENT CO.,LTD

Add: Photoelectric Industrial Park,Economic Development Zone,
Guannan County,Lianyungang City,Jiangsu Province,China
Office: +86(0)51883227526

PROFESSIONAL ENTERPRISING WISDOM CREATES THE FUTURE

TURNKEY SOLUTION FOR SOLAR MODULE PRODUCTION LINE

www.jsgaorun.com

Catalogue

◆ General situation of the company ----- 02	◆ 90D flip inspection ----- 13
◆ Company display ----- 03	◆ Frame handler ----- 13
◆ Whole line diagram ----- 05	◆ Automatic framing ----- 14
◆ Automatic glass loading ----- 07	◆ Frame handler ----- 14
◆ EVA / TPT cutting machine ----- 07	◆ Curing handler ----- 15
◆ Lay up (mechanical type) ----- 08	◆ Corner milling ----- 15
◆ Lay up (robot) ----- 08	◆ 180D turn over ----- 16
◆ Buffer(Short/Long side) ----- 09	◆ Inline standard module machine ----- 16
◆ Automatic tapping machine ----- 09	◆ Hi-pot ----- 17
◆ GR-2203B Auto Bussing ----- 10	◆ Automatic sorting ----- 17
◆ 2nd glass loading machine ----- 11	◆ MES function ----- 18
◆ Glass unloader ----- 11	◆ Cooperative customers ----- 19/20
◆ Edge bonding machine ----- 12	◆ Enterprise qualification ----- 21/22
◆ Automatic Trimming ----- 12	



General situation of the company

Suzhou Gaorun is global turnkey solar panel production line solutions provider, Headquartered in Suzhou, Jiang-su province, China. Since 2007, we started to serve the photovoltaic industry and has been devoted to Solar panel production line for decades. We focus on high demands of automation requirements in the Industry and develop customise solutions of our clients. Gaorun has become leading enterprise with extensive experience and good understanding of the PV industry. Gaorun has a collection of design, sales, research and development of the supply chain comprehensive management center, covers an area of 2000 m2. Production base is located in Lianyungang, Jiangsu province, China, covers an area of 20000m2, more than 300 employees, R&D team over 50 people., Gaorun has its customer footprint across the globe,

Gaorun's business covers research and development, production, engineering, sales and service which is all-round, one-stop.

Gaorun adheres to the highest quality, robust design, consistent performance, customer satisfaction with its cost-effective products and services continuously to create value for customers. We introduce and reserve talents, and are committed to actively looking for various possibilities, continuous technology and product innovation, challenge the impossibility, climb to new heights. Gaorun will continue to strengthen the concept of better service to meet the majority of customers, let us hand in hand.

Company display

Suzhou R&D Base



Lianyungang production base

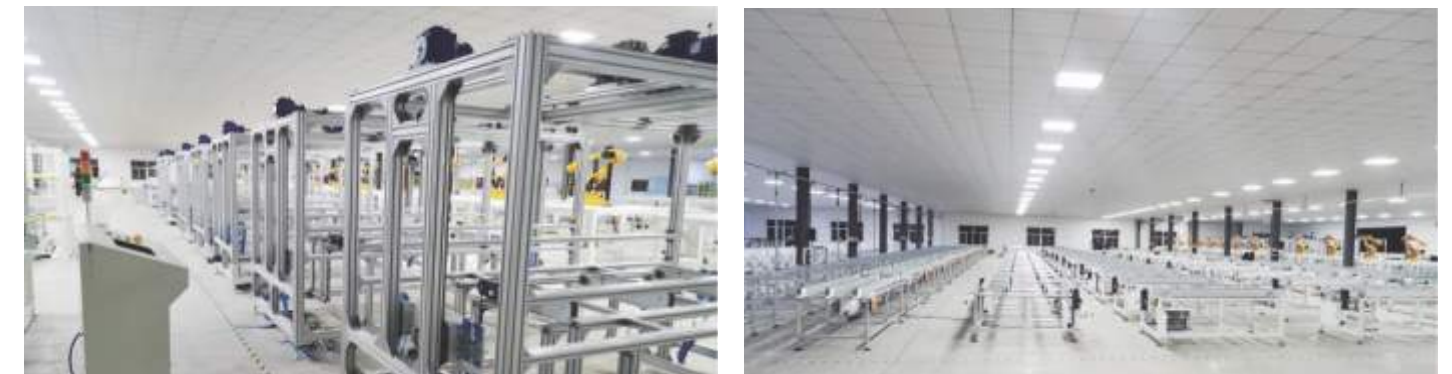

Whole line diagram

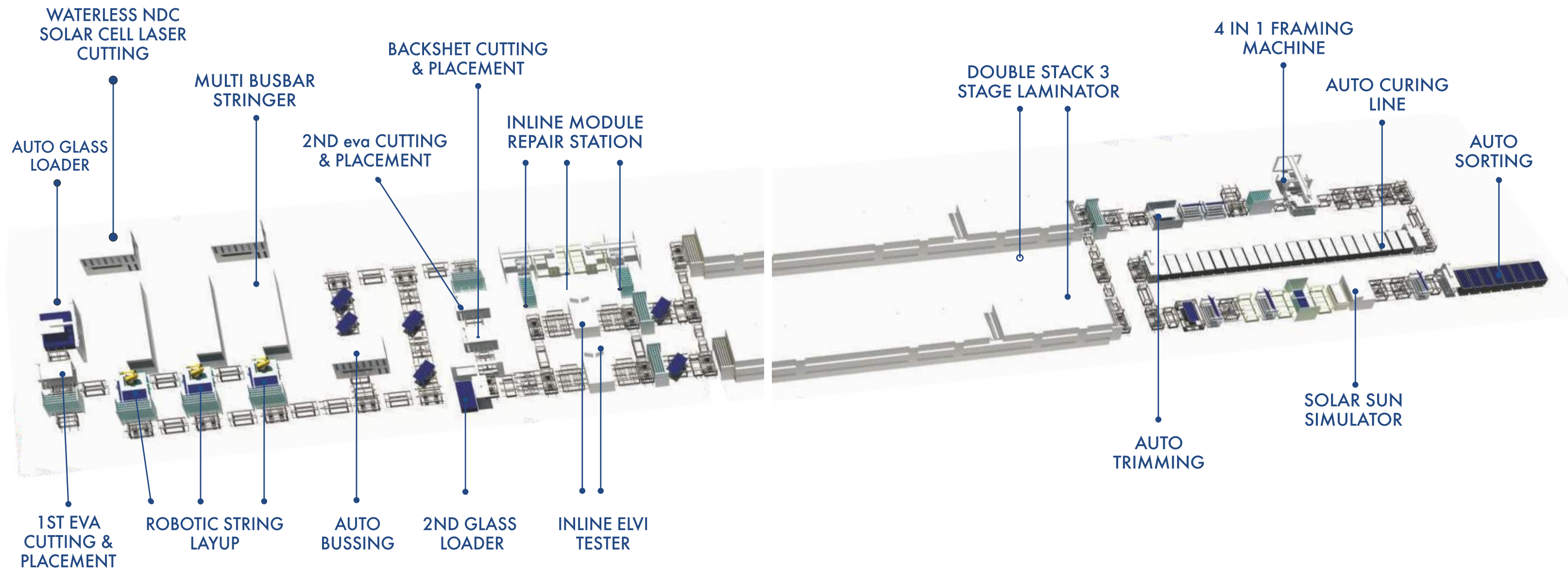

Automatic glass loading

Function Introduction

Automatically absorb the glass to the assembly line and automatically remove the glass separator

Parameter

- ◆ Applicable components: conventional, half sheet and double glass components in length 1640-2600mm & width 950-1500mm
Working beat: 22 seconds
- ◆ Maximum production capacity: 3,400 pcs / day
- ◆ Online operator: No ◆ Weight: about 2200 k g
- ◆ Rated power (KW): 8KW ◆ Pressure (MPa):0.6-0.8Mpa
- ◆ Interface specification: 12
- ◆ Overall dimension (length, X, width, X, height): 6890mmx-3865mmx2000mm

Advantage Introduction

1. The equipment is driven by servo motor, gear rack drive and linear rail guide, accurate position and smooth operation.
2. The glass carrier suction cup is made of polyurethane material, which will not imprint the glass in the absorption process.
3. The whole machine is equipped with a safety fence for safety protection.
4. The glass feeding part shall be protected by grating, which is convenient and simple for employees to operate.
5. The whole machine is equipped with power off and gas off protection.
6. Automatic control of equipment and no personnel intervention during operation.
7. The operation and programming interface is simple and easy to use.



Lay up (mechanical type)

Function Introduction

Automatic string-welded battery laying by a linear motor

Parameter

- ◆ Applicable components: conventional, half sheet and double glass components within length 1640-2600mm & width 950-1500mm
- ◆ Working beat: 6 seconds / string
- ◆ Maximum production capacity: 3,400 pcs / day
- ◆ Online operator: 0 ◆ Rated power (KW): 6KW
- ◆ Gas consumption (L/min): 60 L/min ◆ Pressure (MPa):0.6-0.8MPa
- ◆ Interface specification: 12 ◆ weight:2850KG
- ◆ Overall dimension (length, X, width, X, height): 4770mmx2840mmx2250mm

Advantage Introduction

1. The battery adopts CCD visual positioning, which has the advantages of high accuracy and stability;
2. The equipment can automatically receive, automatically layout and automatically export components, and layout is accurate positioning;
3. The suction cup is made of imported silicone material, which will not leave a mark on the surface of the battery;
4. Adopt the three-axis mechanical motion mode (rotating 180°);
5. The lateral movement adopts linear motor module, which has the advantages of fast movement speed, high repeated positioning accuracy and stable performance, Save the overall beat time;
6. Long and short edge change adjustment adopts quick locking mechanism, adjustment quickly, simple, convenient and reliable;

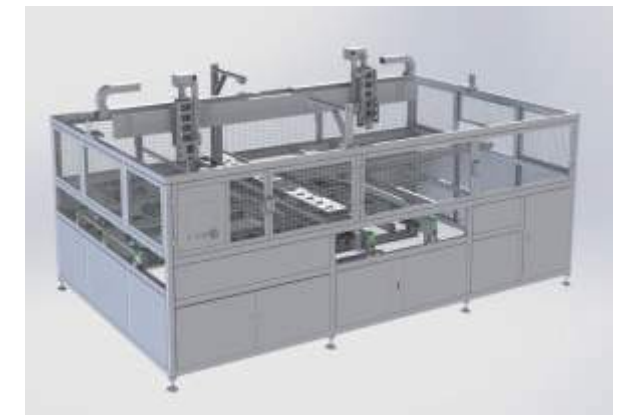

EVA / TPT cutting machine



Function Introduction

Auto-trim EVA / TPT for the assembly

Parameter

- ◆ Applicable components: conventional and double glass components in length 1640-2600mm & width 950-1500 mm
- ◆ Working beat: 22 seconds
- ◆ Maximum production capacity: 2,979 pcs / day
- ◆ Online operator: No ◆ Weight: about 2000 kg
- ◆ Rated power (KW): 4KW ◆ Gas consumption (L/min): 38 L/min
- ◆ Pressure (MPa):0.6-0.8MPa ◆ Interface specification: 12
- ◆ Noise (dbA): <72db
- ◆ Overall dimension(length,X,width, X, height): 5,300 mmx2600mmx1500mm

Advantage Introduction

1. The equipment is driven by a servo motor, with gear and rack drive and linear rail guide, which has the advantages of accurate position and smooth operation;
2. The equipment includes EVA feeding auxiliary carrier for employees;
3. The stretching speed of EVA material roll can be automatically adjusted according to the tension to ensure the stable operation of EVA stretching;
4. EVA cutting is the overall cutting type, to ensure that the incision is smooth and neat;
5. The EVA cutting accuracy is $\pm (0.5 + 0.15\%L)$, and the diagonal error of EVA after cutting is $\pm 1.5\text{mm}$ after cutting;
6. EVA laying includes automatic correction function, and EVA range \pm within 2mm;
7. The main parts of the equipment are equipped with safety protection cover and dust cover;

Lay up (robot)



Function Introduction

The string-welded battery is automatically laid by the robot

Parameter

- ◆ Applicable components: conventional, half sheet and double glass components in length 1640-2600mm & width 950-1500mm
- ◆ Working beat: 5 seconds / string ◆ Online operator: 0
- ◆ Rated power (KW): 6KW ◆ Gas consumption (L/min): 60 L/min
- ◆ Pressure (MPa):0.6-0.8MPa ◆ Interface specification: 12
- ◆ Overall dimension (length, X, width, X, height): 3,380 mmx3120mmx1800mm
- ◆ weight:2000kg

Advantage Introduction

1. The battery adopts CCD visual positioning, which has the advantages of high accuracy and stability;
2. The equipment can automatically receive, automatically layout and automatically export components, and layout is accurate positioning;
3. The suction cup is made of imported silicone material, which will not leave a mark on the surface of the battery;
4. Adopt six-axis robot typesetting, with the advantages of fast movement speed, high flexibility, high flexibility, high repeated positioning accuracy and stable performance, saving the overall beat time;
6. Long and short edge change adjustment adopts quick locking mechanism, adjustment quickly, simple, convenient and reliable;

Buffer(Short/Long side)

Function Introduction

The device is used for the storage of components.
Before the current station component flows away, the previous station component can flow to the device for a temporary stay

Parameter

- ◆ Applicable components: conventional, half sheet and double glass components in length 1640-2600mm & width 950-1500mm
- ◆ Working beat: 22 seconds
- ◆ Online operator: No
- ◆ Rated power rating (KW):1.5KW
- ◆ Interface Specifications: No
- ◆ Overall dimension (long X width X height): 2900mmX2100mmX3000mm (short edge) 3,000 mmX1700mmX3000mm (long side)
- ◆ Maximum production capacity: 3,400 pcs / day
- ◆ Weight: about 2600kg (short) & 950kg (long)
- ◆ Pressure (MPa): No
- ◆ Noise (dbA): <72db

Advantage Introduction

1. The equipment is driven by ordinary motor, double-row chain transmission and straight groove steel guidance, which has the advantages of accurate position and smooth operation;
2. The whole machine is equipped with a safety fence, which has the safety protection function;
3. Automatic control of the equipment, and the operation process does not require personnel intervention;
4. The bracket and the transmission part are a separate whole, with the advantages of assembly, transportation, debugging and simplicity;
5. The component storage support adopts welded steel structure, and the contact part with the component is covered with thermoplastic pipe;



GR-2203B Auto Bussing



Function Introduction

The cell induction soldering head is used to interconnect and solder the bus ribbon at the head, middle and tail of the outgoing line type assembly; it has the function of coil bus ribbon feeding belt and bending U-and L-type leads upward. Higher speed; compatible with larger size modules.

Characteristics

- ◆ Cycle time 17s, high speed.
- ◆ Strong compatibility : compatible with Multi-shard of 6 strings , 5 strings single Bypass soldering and 6 strings double Bypass soldering
- ◆ Corrects twice to the position of the 10 / 12 series half piece cell string, grabs the cell string by vacuum adsorption, one time empty soldering and high welding accuracy.
- ◆ Convenient specification conversion.
- ◆ Can punch at the end of the bus ribbon
- ◆ Single side feeding, easy to operate
- ◆ Double Bypass soldering integration can meet the customer's demand for 6 strings double Bypass soldering of bypass bus ribbon, can be closed or opened according to the actual use demand.
- ◆ The smallest floor area, the lowest CoO.

Specifications

- ◆ Cycle time :17sec/panel(single bypass soldering)
21 sec/panel (opening Double bypass soldering)
- ◆ Activation:≥ 98%;
- ◆ Cell Specification:166mm-230mm;
- ◆ Panel specification:
A.156-180 Cell: 6 strings x 10 half pieces x 2; 6strings x 11 half pieces x 2;
6 strings x 12 half pieces x 2; 6stings x 13 half pieces x 2
B.182 Cell: 6 strings x 9 pieces x 2 :
C.210Cell 6 strings x 10 half pieces x 2 : 6strings x 15 one third pieces x 2:
D.210Cell 5 strings x 10 half pieces x 2 : 5 strings x 15 one third pieces x 2
- ◆ Cell space: -0.5-4mm;
- ◆ String space: 1-6mm;bypass soldering of String space:≥10mm;
- ◆ Glass specification: width (980-1500mm)x length(1720-2600mm);
- ◆ Correction accuracy of cell string: ≤± 0.25mm;
- ◆ Equipment power supply: three-phase 380V 50/60Hz;
- ◆ Power: peak 35kW;average 25kW;
- ◆ Air: positive pressure 0.6~0.8MPa, negative pressure about- 70kPa;
- ◆ Equipment size:length x width x height:6580x5604x2621 mm (including two assembly lines)

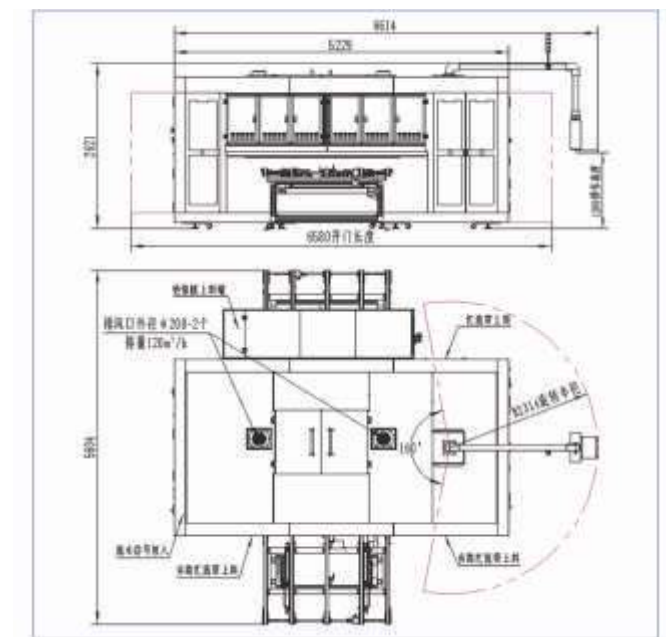

Automatic tapping machine

Function Introduction

Automatically tape the assembly

Parameter

- ◆ Applicable component specifications: conventional, half sheet and double glass components in length 1640-2600mm & width 950-1500mm
- ◆ Working beat: 22 seconds
- ◆ Online operator: 0
- ◆ Rated power (KW): 3KW
- ◆ Gas consumption (L/min):3.8L/min
- ◆ Noise (dbA): <72db
- ◆ Overall dimension (length, X, width, X, height): 3150 mmx2000mmx1800mm
- ◆ Maximum production capacity: 3,400 pcs / day
- ◆ Weight: about 600 KG
- ◆ Pressure (MPa):0.6~0.8MPa
- ◆ Interface specification: 12

Advantage Introduction

1. Automated operation form reduces the manual tape link;
2. Realize the integration of cut-off and paste, and realize the real full automation;
3. The paste position is accurate to avoid the waste caused by manual paste;
4. Servo drive, with high paste accuracy;
5. Computer programming and control, highly intelligent, simple and easy to operate;



2nd glass loading machine

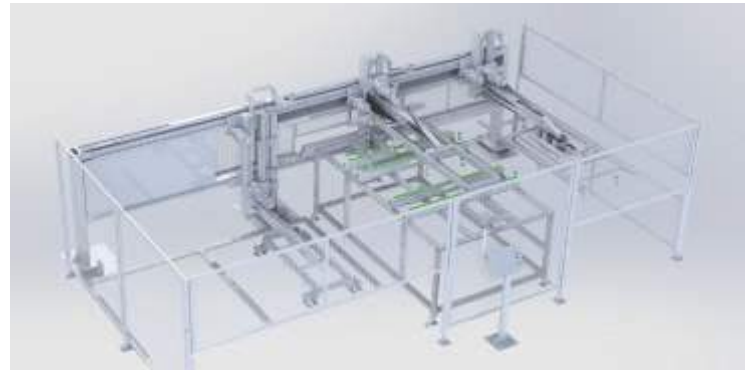

Function Introduction

The suction cup is used to absorb the second-floor glass of the double-wave assembly after the closing sheet.

Parameter

- ◆ Applicable components: conventional, half sheet and double glass components in length 1640-2600mm & width 950-1500mm
- ◆ Working beat: 22 seconds
- ◆ Maximum production capacity: 3,400 pcs / day
- ◆ Online operator: 0
- ◆ Rated power (KW): 5KW
- ◆ Gas consumption (L/min): 60 L/min
- ◆ Pressure (MPa): 0.6-0.8MPa
- ◆ Interface specification: 12
- ◆ Overall dimension (length, X, width, X, height): 7000mmx-3800mmx2000mm
- ◆ weight: 1700KG

Advantage Introduction

1. Choose servo motor for high transfer accuracy and stable transmission performance;
2. Advanced design principles and processing methods to ensure the reliability of the whole machine operation;
3. Automatic whole-process control to avoid personnel intervention and high production efficiency;
4. The whole machine is equipped with a safety fence, which has the safety protection function;
5. Computer programming and control, highly intelligent, simple and easy to operate;
6. Convenient installation, energy saving and environmental protection, easy to maintain, and low price;

Function Introduction

The suction cup is used to absorb the second-floor glass of the double wave component after the sheet to repair

Parameter

- ◆ Applicable components: conventional, half sheet and double glass components in length 1640-2600mm & width 950-1500mm
- ◆ Working beat: 22 seconds
- ◆ Maximum production capacity: 3,400 pcs / day
- ◆ Online operator: 0
- ◆ Gas consumption (L/min): 60 L/min
- ◆ Interface specification: 12
- ◆ Overall dimension (length, X, width, X, height): 3,650 mmx3300mmx2900mm
- ◆ Rated power (KW): 3KW
- ◆ Pressure (MPa): 0.6-0.8MPa
- ◆ weight: 1640KG

Advantage Introduction

1. Choose servo motor for high transfer accuracy and stable transmission performance;
2. Advanced design principles and processing methods to ensure the reliability of the whole machine operation;
3. Automatic whole-process control to avoid personnel intervention and high production efficiency;
4. The whole machine is equipped with a safety fence, which has the safety protection function;
5. Computer programming and control, highly intelligent, simple and easy to operate;
6. Convenient installation, energy saving and environmental protection, easy to maintain, and low price;

Glass unloader

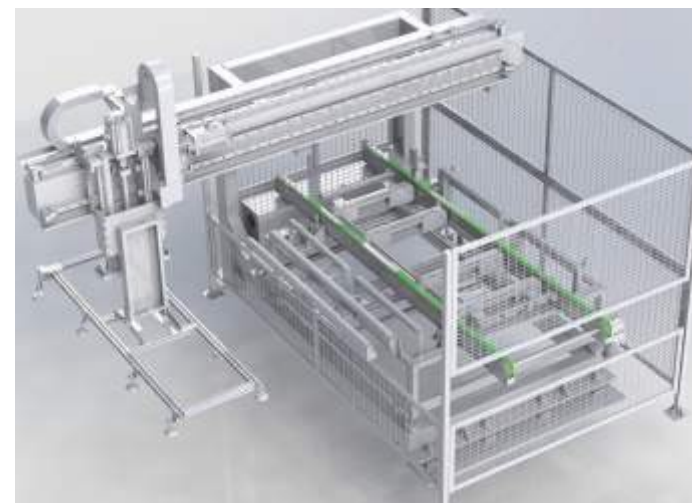

Edge bonding machine



Function Introduction

High temperature tape is used to seal the four sides of the double glass assembly before lamination

Parameter

- ◆ Applicable components: conventional, half sheet and double glass components in length 1640-2600mm & width 950-1500mm
- ◆ Working beat: 22 seconds
- ◆ Maximum production capacity: 3,400 pcs / day
- ◆ Online operator: 0 people
- ◆ Rated power: 2KW
- ◆ Gas consumption: 60 L/min
- ◆ Pressure: 0.6-0.8MPa
- ◆ Interface specification: 12
- ◆ Overall dimension (length, X, width, X, height): 3,660 mm X 2500mm X 1650mm
- ◆ weight: 1800KG

Advantage Introduction

1. Choose servo motor for high displacement accuracy and stability;
2. The equipment includes the assembly leveling and fixing mechanism, with a total of 16 suction cups leveling out the components;
3. The 16 suction cups are made of imported silicone material, and the equipment will not leave a mark on the surface of the component when working;
4. The suction cup is designed as an integral integrated type, adjusted quickly, simple, convenient and reliable;
5. The equipment completes the automatic operation without manual operation.
6. Long and short edge change adjustment adopts quick locking mechanism, adjustment quickly, simple, convenient and reliable;

Automatic Trimming



Function Introduction

Cut the excess backplane and EVA around the laminated assembly

Parameter

- ◆ Applicable components: conventional, half sheet and double glass components of length 1640-2600mm & width 950-1500mm
- ◆ Working beat: 22 seconds
- ◆ Maximum production capacity: 3,400 pcs / day
- ◆ Online operator: No
- ◆ Weight: approximately 2150kg
- ◆ Rated power (KW): 2KW
- ◆ Pressure (MPa): 0.6-0.8MPa
- ◆ Interface specification: 12
- ◆ Noise (dbA): <72db
- ◆ Overall dimension (length, X, width, X, height): 3,520 mmx2240mmx1200mm

Advantage Introduction

1. The equipment is driven by a servo motor, which has the advantages of accurate precision and smooth operation;
2. The whole machine is equipped with a safety fence, which has the safety protection function;
3. Automatic control of the equipment, and the operation process does not require personnel intervention;
4. When working, the four sides of the component are cut at the same time, which has the advantages of high efficiency and stability;
5. Set up the guide device to prevent the waste material from splashing;
6. The blade adopts circular arc edge, cut clean, and uses the blade back edge to effectively remove the residual material of the component;
7. Easy to replace the blade;

90D flip inspection



Function Introduction

The device uses 12 sets of LED lamps on the back to detect hidden cracks and impurities inside the assembly

Parameter

- ◆ Applicable components: conventional, half sheet and double glass components in length 1640-2600mm & width 950-1500mm
- ◆ Working beat: 22 seconds
- ◆ Maximum production capacity: 3,400 pcs / day
- ◆ Online operator: 1 person ◆ Weight: approximately 1080kg
- ◆ Rated power (KW): 2KW ◆ Pressure (MPa):0.6-0.8MPa
- ◆ Gas consumption (L/min):3.8L/min
- ◆ Interface specification: 12 ◆ Noise (dbA): <72db
- ◆ Overall dimension (length, X, width, X, height): 2,900 mmX_2100mmX2150mm

Advantage Introduction

1. The equipment has the advantages of stable transmission and accurate accuracy;
2. Before flipping over, the device contains the regulation function to accurately position the components;
3. When the component is in place, people can clearly identify the component battery through the cylinder jacking up and the upper LED irradiation;
4. The flip mechanism adopts the motor driven chain structure, and the flip is firm and reliable
5. The equipment adopts steel structure welding frame, with high strength, and the whole machine is solid and reliable during transmission;
6. Include the manipulator limit mechanism after the flip is in place;
7. Reasonable equipment design structure, overall beauty and other features.

Frame handler



Function Introduction

Automatic aming of automatically (used with frame glue machine)

Parameter

- ◆ Applicable components: conventional, half sheet and double glass components in length 1640-2600mm & width 950-1500mm
- ◆ Working beat: 22 seconds
- ◆ Maximum production capacity: 3,400 pcs / day
- ◆ Online operator: 0 people ◆ Rated power: 6.0KW
- ◆ Gas consumption: 60 L/min ◆ Pressure: 0.6-0.8MPa
- ◆ Interface specification: 12 ◆ weight:1400KG
- ◆ Overall dimension (length, X, width, X, height): 4,700 mm X 3900mm X 3000mm

Advantage Introduction

1. Choose servo motor for high displacement accuracy and stability;
2. The equipment includes a component leveling mechanism, with a total of 16 suction cups leveling the components;
3. The 16 suction cups are made of imported silicone material, and the equipment will not leave a mark on the surface of the component when working;
4. The suction cup design is an integral integrated type, adjust the hand shake handle structure, the adjustment is fast, simple, convenient and reliable;
5. The equipment includes the profile straightening mechanism, which can facilitate the straightening of the long and short borders;
6. Long and short edge change adjustment adopts quick locking mechanism, adjustment quickly, simple, convenient and reliable;



Automatic framing

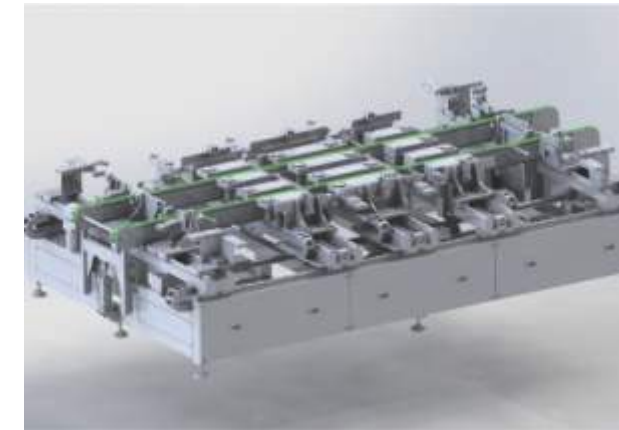

Function Introduction

Automatic aming of components (used with frame ding machine)

Parameter

- ◆ Applicable components: conventional and double glass components in length 1640-2600mm & width 950-1500mm
- ◆ Working beat: 22 seconds
- ◆ Maximum production capacity: 3,400 pcs / day
- ◆ Online operator: 0 people ◆ Rated power: 4KW
- ◆ Gas consumption: 60 L/min ◆ Pressure: 0.6-0.8MPa
- ◆ Interface specification: 12 ◆ weight:2550KG
- ◆ Overall dimension (length, X, width, X, height): 3,500 mm X 2650mm X 950mm

Advantage Introduction

1. Choose servo motor for high displacement accuracy and stability;
2. The equipment includes a component leveling mechanism, with a total of 16 suction cups leveling the components;
3. The 16 suction cups are made of imported silicone material, and the equipment will not leave a mark on the surface of the component when working;
4. The suction cup design is an integral integrated type, adjust the hand shake handle structure, the adjustment is fast, simple, convenient and reliable;
5. The equipment includes the profile straightening mechanism which can facilitate the straightening of the long and short borders;
6. Long and short edge change adjustment adopts quick locking mechanism, adjustment quickly, simple, convenient and reliable;



Frame handler

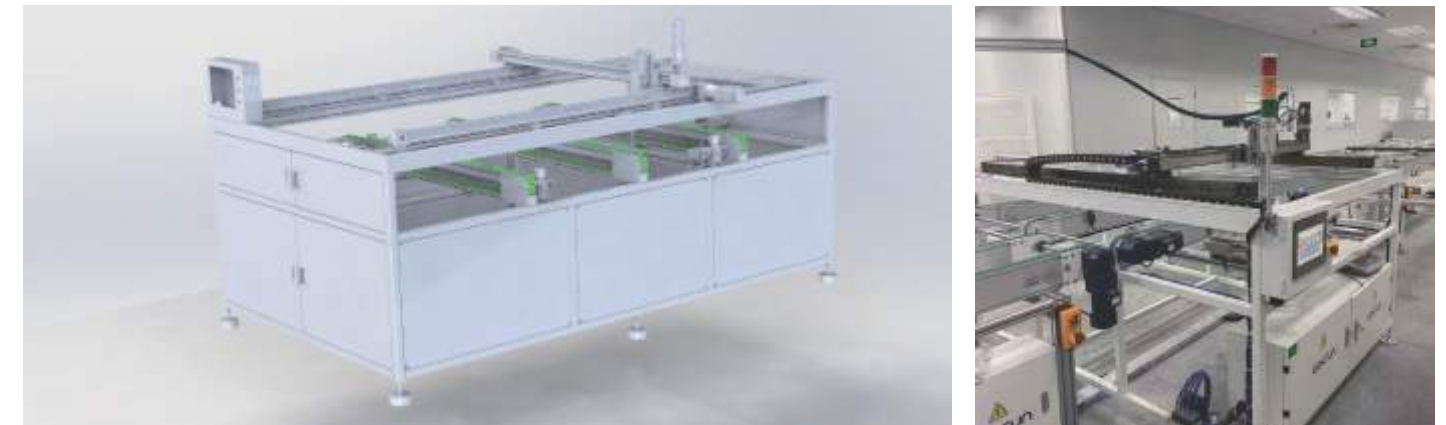

Function Introduction

Automatic glue of junction box (with A / B mixed glue machine)

Parameter

- ◆ Applicable components: Regular and double glass components in length 1640-2600mm & width 950-1500mm working beat: 22 seconds
- ◆ Maximum production capacity: 3,400 pcs / day
- ◆ Weight: approximately 850kg ◆ Online operator: No
- ◆ Rated power rating (KW):1.82KW ◆ Pressure (MPa):0.6-0.8MPa
- ◆ Interface specification: 12 ◆ Noise: <72db
- ◆ Overall dimension (length, X, width, X, height): 3,240 mmx1850mmx1615mm

Advantage Introduction

1. Automated operation form reduces the artificial glue filling link;
2. Accurate ratio, glue glue integration, to achieve real full automation;
3. Stir well to avoid the waste caused by artificial glue;
4. Servo drive, high glue filling accuracy;
5. Computer programming and control, with a high degree of intelligence, simple and easy to operate;

Curing handler



Function Introduction

Hold the assembly to the curing line for curing / grab the assembly from the curing line and put it into the line to let it out

Parameter

- ◆ Applicable components: conventional, half sheet and double glass components in length 1640-2600mm & width 950-1500mm
- ◆ Working beat: 22 seconds
- ◆ Maximum production capacity: 3,400 pcs / day
- ◆ Online operator: No ◆ Weight: about 1,780 k g
- ◆ Rated power rating (KW):6.0KW
- ◆ Pressure (MPa):0.6-0.8MPa
- ◆ Gas consumption (L/min):10.7L/min
- ◆ Interface specification: 12 ◆ Noise (dbA): <72db
- ◆ Overall dimension (l,x,w,x,h) : 3050mm 2960mm 2550mm

Advantage Introduction

1. The equipment is driven by a servo motor, with gear and rack drive and linear rail guide, which has the advantages of accurate operation and smooth operation;
2. The whole machine is equipped with a safety fence, and has the safety protection function;
3. The clip frame is firmly and reliable, and the frame is not scratch;
4. The whole machine is equipped with power off and gas off protection;
5. The equipment is operated automatically, and the operation process does not require personnel intervention;
6. The operation and programming interface is simple and easy to use;

Corner milling

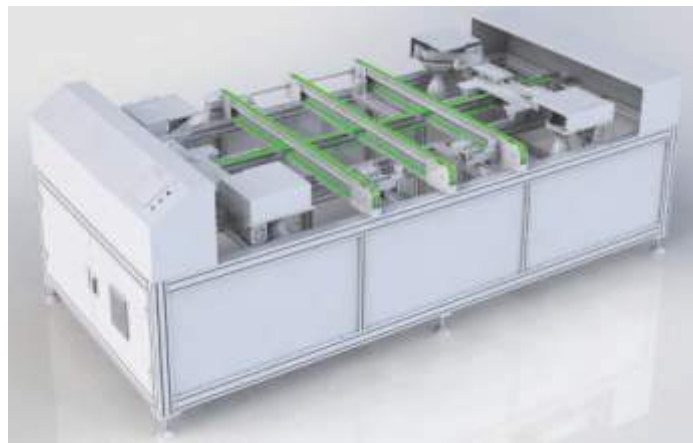

Function Introduction

Polish the toughness angle of the component in the finished frame

Parameter

- ◆ Applicable components: length-1640-2600mm & width-950-1500mm
- ◆ Working beat: 22 seconds
- ◆ Maximum production capacity: 3,400 pcs / day
- ◆ Online operator: No
- ◆ Rated power rating (KW):1.55KW
- ◆ Pressure (MPa):0.6-0.8MPa
- ◆ Gas consumption (L/min): 36 L/min
- ◆ Interface specification: 12
- ◆ Noise (dbA): <72db
- ◆ Overall dimension (length, X, width, X, height): 3,950 mmx1800mmx1100mm
- ◆ weight:1200KG

Advantage Introduction

1. The equipment is driven by a servo motor and transmitted with synchronous belt, with the characteristics of accurate operation and smooth operation;
2. Wear the four corners of the component at the same time to ensure the beat;
3. The sand belt in the grinding angle mechanism has a tensioning mechanism, which is simple and easy to replace;
4. The equipment adopts steel structure welding frame, with high strength, and the whole machine is solid and reliable during transmission;
5. The equipment is operated automatically, without personnel intervention in the operation process;

180D turn over

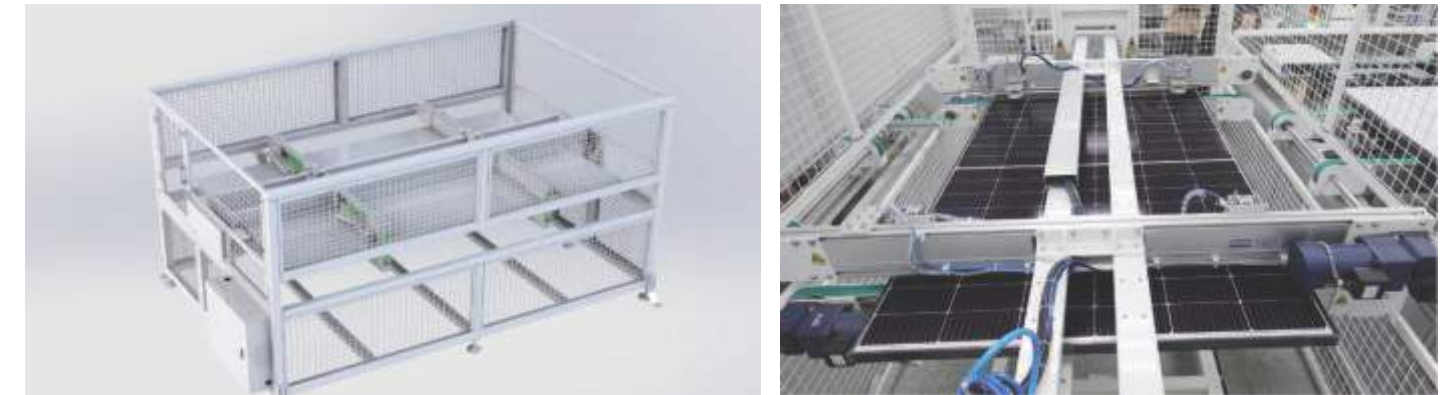

Function Introduction

Flip the assembly to facilitate the rear channel cleaning station

Parameter

- ◆ Applicable components: conventional and double glass components in length 1640-2600mm & width 950-1500mm
- ◆ Working beat: 22 seconds
- ◆ Maximum production capacity: 3,400 pcs / day
- ◆ Online operator: 0 people ◆ Weight: about 1,200 k g
- ◆ Rated power (KW): 1KW ◆ Pressure (MPa):0.6-0.8MPa
- ◆ Gas consumption (L/min):3.8L/min
- ◆ Interface specification: 12 ◆ Noise (dbA): <72db
- ◆ Overall dimension (length, X, width, X, height): 3,300 mmX-1900mmX1700mm

Advantage Introduction

1. The equipment adopts steel structure welding frame, with high strength, and the whole machine is solid and reliable during transmission;
2. Position and clamp the components before flipping, and the components will not tremble during flipping;
3. Reduce the labor intensity, and can better maintain the production rhythm to ensure the production efficiency;
4. The flipping motor adopts large torque motor and frequency converter control, which has the advantages of smooth flipping, accurate and in place;
5. The whole machine is equipped with a safety fence, and has the safety protection function;
6. Automatic control of the equipment, and the operation process does not require personnel intervention.

Inline standard module machine

Function Introduction

Store standard component versions for automatic calibration of IV testing.

Parameter

- ◆ Applicable component specifications: conventional, half sheet and double glass components in length 1640-2600mm & width 950-1500mm
- ◆ Working beat: 22 seconds
- ◆ Maximum production capacity: 3,400 pcs / day
- ◆ Online operator: 0
- ◆ Weight: approximately 1100 KG
- ◆ Rated power (KW): 2KW
- ◆ Pressure (MPa):0.6-0.8MPa
- ◆ Gas consumption (L/min):3.8L/min
- ◆ Interface specification: 12
- ◆ Noise (dbA): <72db
- ◆ Overall dimension (length, X, width, X, height): 3,150 mmx1800mmx-1850mm

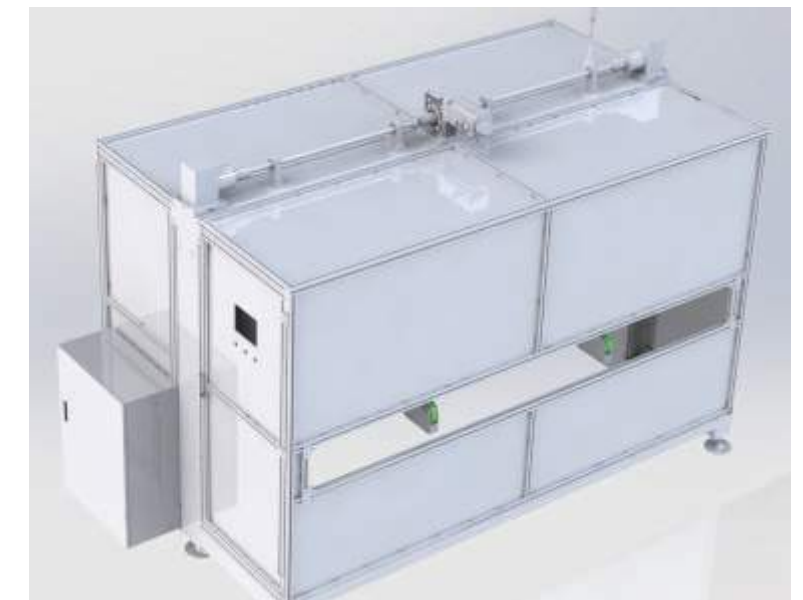

Advantage Introduction

1. Prevent damage of standard board and the IV test power of university calibration.
2. Automatic control of the equipment and no personnel intervention.
3. The whole machine is equipped with a safety fence, with a safety protection function;

Hi-pot



Function Introduction

Test for the standard insulation of the assembly

Parameter

- ◆ Applicable components: conventional, half sheet and double glass components in length 1640-2600mm & width 950-1500mm
- ◆ Working beat: 22 seconds
- ◆ Maximum production capacity: 3,400 pcs / day
- ◆ Online operator: 0 people
- ◆ Rated power rating (KW):2.0KW
- ◆ Pressure (MPa):0.6-0.8MPa
- ◆ Overall dimension (length, X, width, X, height): 3200mm 1850mm 1400mm
- ◆ weight:980KG

Advantage Introduction

1. Equipment movement is stable and accurate in place;
2. Component positioning, energize, automatically test pressure resistance after grounding, and automatic alarm when bad;
3. Before the test, the components are lifted up through the insulation pad to ensure the safety of the test and personnel;
4. Docking with the signal of the insulation withstand voltage tester;
5. A transparent protective cover is installed on the outside to facilitate the personnel to observe the data of the pressure withstand tester and eliminate the alarm points in time;

Automatic sorting



Function Introduction

Flip the assembly to facilitate the rear channel cleaning station

Parameter

- ◆ Applicable component specifications: conventional, half sheet and double glass components in length 1640-2600mm & width 950-1500mm
- ◆ Working beat: 22 seconds
- ◆ Maximum production capacity: 3,400 pcs / day
- ◆ Online operator: 0
- ◆ Weight: about 2350 K G
- ◆ Rated power (KW): 12KW
- ◆ Pressure (MPa):0.6-0.8MPa
- ◆ Gas consumption (L/min):3.8L/min
- ◆ Interface specification: 12
- ◆ Noise (dba): <72db
- ◆ Overall dimension (l, x, w, x, h): 12,700 mm x 3850mm x - 2800mm

Advantage Introduction

1. The equipment is driven by servo motor, driven by gear rack, and linear rail guide, accurate and smooth operation;
2. The component carrier suction cup is made of polyurethane material, which will not imprint the glass in the absorption process;
3. The whole machine is equipped with a safety fence, and has the safety protection function;
4. The upper and lower parts of the packing box is convenient and simple for staff operation;
5. The whole machine is equipped with power off and gas break protection;
6. Automatic control of the equipment, requiring no personnel intervention during the operation process;
7. The operation and programming interface is simple and easy to use;
8. Intelligent vision system guides the manipulator to accurate positioning.

MES function

Function description

◆Production monitor:

Monitor Operating status of equipments in real time, the result is displayed by pictures which is easy to understand.

◆Data collection:

Collect pointed data in real time and write it to database for record and query.

◆Email:

At the beginning of each month, the data will be transferred to pointed people by Email for analysis.

◆Voice broadcast:

Distinguish warning sign and broadcast the important ones.

◆System management:

There are three modes for system operation : Admin,User,Maintain.

◆Maintenance:

Support config modules and adjust according to different process.

◆Fool-proof:

Combine with ERP and accept Barcode scanning mode instead of manual work, it helps to reduce error rate.

◆Quality track:

All the data will be saved in hard disk .People can find record if customer complaint.



MES Pattern

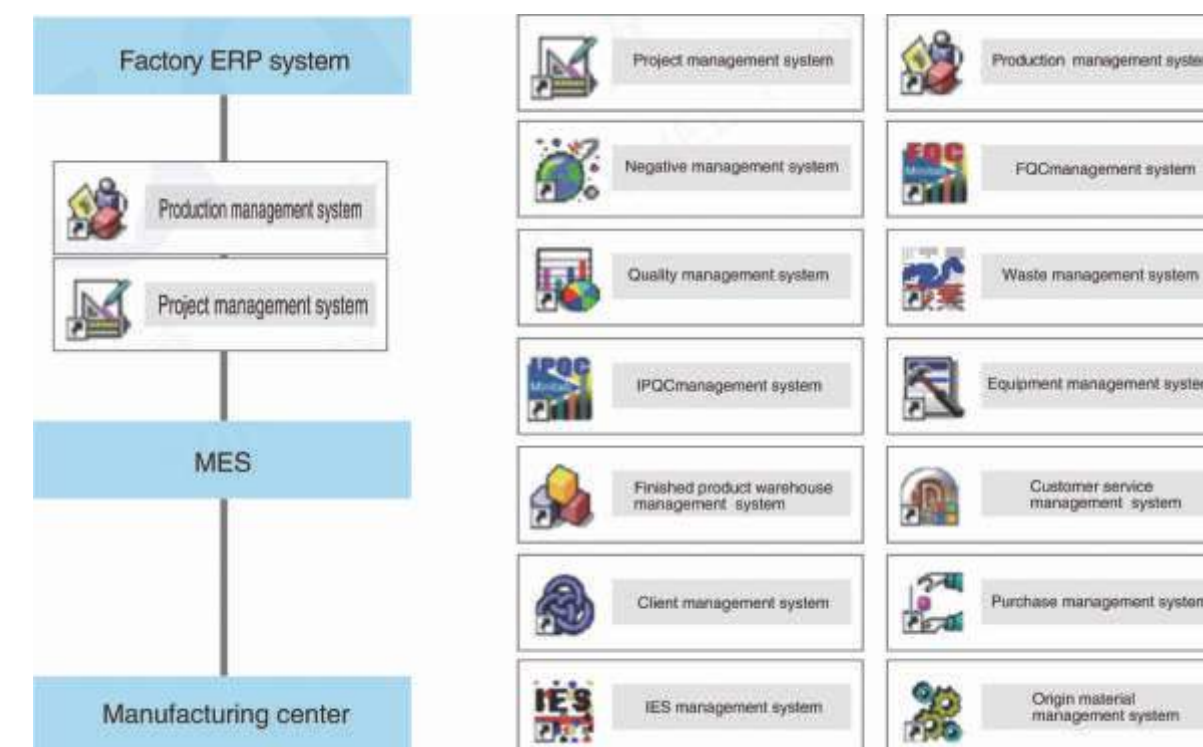

Cooperative customers

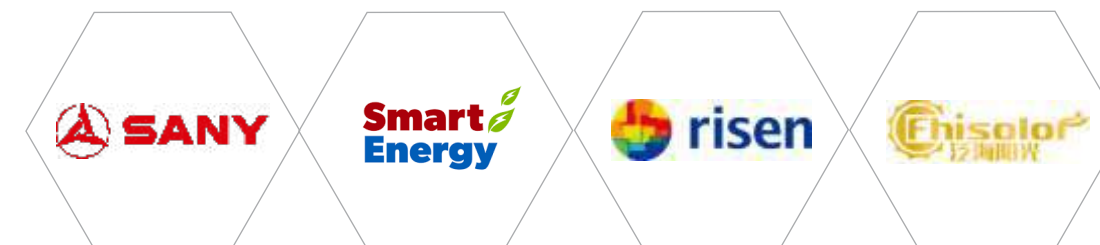

Enterprise qualification

Authentication



Enterprise qualification

Patent



Honor

